

# Buckshaw Village, Chorley.

North

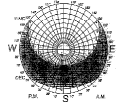

11/579

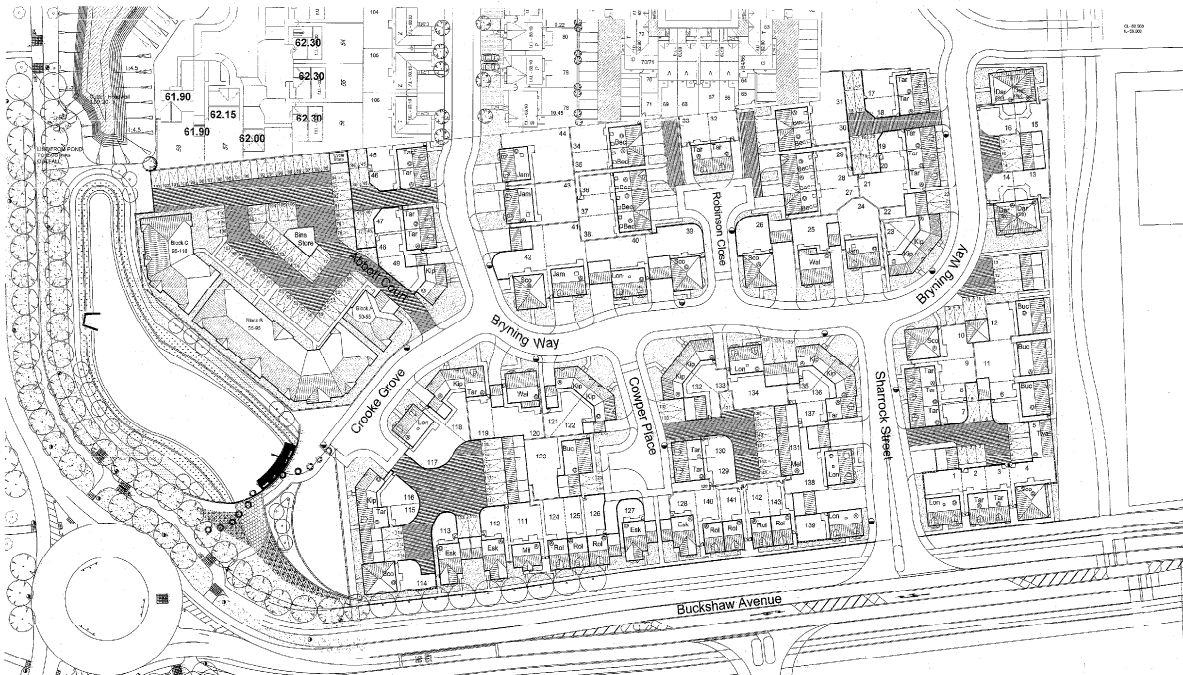

Block	Type	Count	Area (sqm)
Block A	Type A	3	500
	Type B	3	500
	Type C	4	500
	Type D	4	500
	Type E	4	500
	Type F	4	500
Block B	Type G	3	500
	Type H	3	500
	Type I	3	500
Block C	Type J	3	500
	Type K	3	500
	Type L	3	500
<b>TOTAL</b>		<b>120</b>	<b>18000</b>

RMW AREA = 3.25 Hectares (8.00 Acres)  
 GCA AREA = 2.24 Hectares (5.59 Acres)  
 NET DENSITY = 53.0 DPH/HECTARE

Item	Description	Quantity	Unit
1	Site Preparation	1	LOT
2	Excavation	1	LOT
3	Foundation	1	LOT
4	Structure	1	LOT
5	Roofing	1	LOT
6	Internal Works	1	LOT
7	External Works	1	LOT
8	Landscaping	1	LOT
9	Final Works	1	LOT

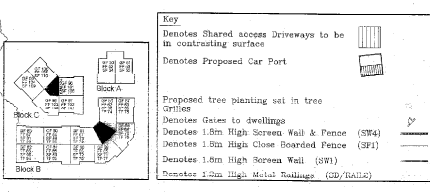

### PART M - Access for the Disabled

THE FOOTPATHS SHOWN TO PROPERTIES IS INDICATIVE OF THE GENERAL ARRANGEMENT TO ENSURE COMPLIANCE WITH APPROVED DOCUMENT PART M (ACCESS FOR DISABLED) OF THE BUILDING REGULATIONS.

SITE CONSTRAINTS MAY CHANGE THE POSITIONS AND CONSTRUCTION DETAIL FOR ACCESS TO THE PROPERTY HOWEVER THE EXTENT OF THESE VARIATIONS ARE LIKELY TO BE MINIMAL. REFER TO IFC No. M4/PM1 FOR SUITABLE SOLUTIONS.

SHOULD YOU REQUIRE FURTHER CLARIFICATION, PLEASE ASK OUR SALES REPRESENTATIVE.

**CDM NOTES**  
 EXISTING PUBLIC SEWER EASEMENT BASED ON SURVEYED MAINLINE POSITIONS. OUR CARE TO BE TAKEN WHEN EXCAVATING NEAR THIS AREA.  
 DWELLINGS SPACED SO THAT A SUFFICIENT WORKING PLATFORM MAY BE MAINTAINED DURING THE CONSTRUCTION PROCESS AND ANY FUTURE MAINTENANCE.



Job No: WHITFIELD PARK  
 BUCKSHAW VILLAGE, CHORLEY

Drawn	Checked	Authorised
1:500	PL/01	AR